

THIS DRAWING IS THE PROPERTY OF MOUCHEL BUSINESS SERVICES. COPYRIGHT IS RESERVED BY THEM AND THE DRAWING IS ISSUED ON THE CONDITION THAT IT IS NOT COPIED, REPRODUCED, RETAINED, OR DISCLOSED TO ANY UNAUTHORISED PERSON, EITHER WHOLLY OR IN PART WITHOUT THE CONSENT IN WRITING OF MOUCHEL BUSINESS SERVICES.

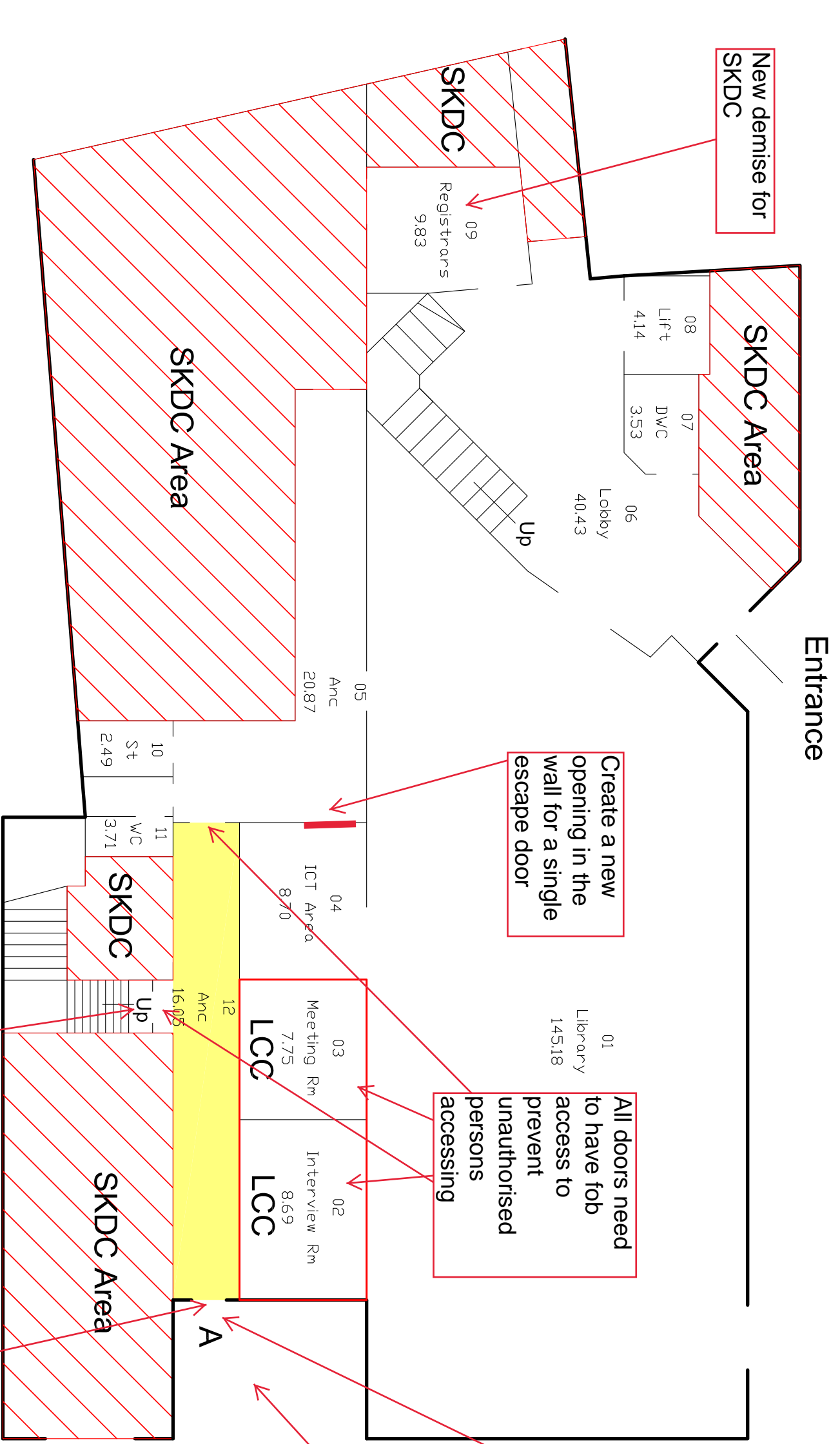

New demise for SKDC

Create a new opening in the wall for a single escape door

All doors need to have fob access to prevent unauthorised persons accessing

Access door needs to be linked to the intruder alarm

The bin are to be reconfigured and gates improved to create a access route for the registrars

Fire escape route push bar

New access door with fire escape push bar, including fob access

Ground Floor

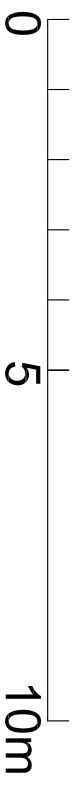

rev.	Date	Description	By	Checked By



Client  
MOUCHEL PROPERTY RECORDS

Project  
S4132  
Bourne South Kesteven Community Point (Library and Register Office)  
Drawing Title  
Floor Plan 1

Drawn By	Checked By
JDH	
Scale	Date
N.T.S.	August 2013
Project No.	Drawing No.
Revision	

Drawing Status